

FLOCARE® BUTTON EXTENSION SET*

INSTRUCTIONS FOR USE & CLEANING INSTRUCTIONS

YOU WILL NEED:

- Flocare Button Extension Set
- Water for flushing
- A 60ml syringe

Check all expiry dates and wash hands thoroughly

Open the packaging and lay contents on a clean dry surface



1



Open the purple cap

2



Attach the syringe and flush the extension set with water, as advised by your healthcare professional

3



Remove the syringe and close the clamp on the extension set

4



Open the top of your Button/Low Profile Gastrostomy

5



Match the markings on the extension set to the markings on the feeding tube and gently push in until secure

6

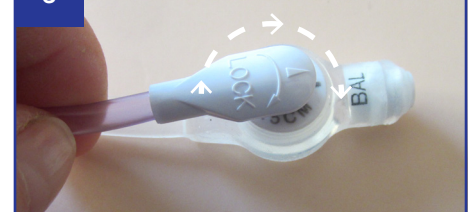

Once inserted, turn the extension set clockwise by half a turn to lock into position and prevent it falling out

7

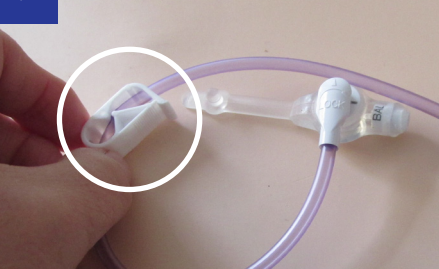

Attach your syringe or giving set and open the clamp to allow your prescribed feed/water/medication to pass safely through your feeding tube

8

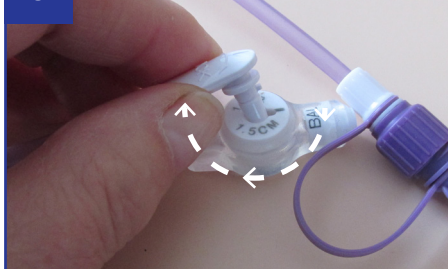

When finished, close the clamp and turn the extension set half a turn anti-clockwise to match up the markings, gently pull the extension set to remove from the tube

9



Replace the top on the feeding tube to prevent any leakage. The extension set should be cleaned/changed as directed by your healthcare professional

*Please note, this item is single patient use and is recommended to be used for up to 2 weeks only. Total use time can vary and your healthcare professional will advise of when to replace it.

FLOCARE® BUTTON EXTENSION SET*

INSTRUCTIONS FOR USE & CLEANING INSTRUCTIONS



To reduce the risk of contamination wash the Flocare Button extension sets thoroughly after every use, using the following instructions.

❶ Close the clamp and turn the extension set anti-clockwise to match up the markings. Gently pull the extension set to remove it from the button.

❷ Open the clamp and wash thoroughly in warm soapy water. Using a brush, clean the connectors to remove any build up in the threads.

❸ Flush with at least 60ml sterile/cool boiled water to remove any soap remnants.

IF USING FOR MORE THAN 7 DAYS (MAXIMUM 14 DAYS)

❹ Flush with at least 60ml sterilising solution, suitable for use with plastic products.

❺ Rinse thoroughly with sterile/cool boiled water to remove any sterilising solution.

❻ Allow to air dry in a hanging position. Store in an air tight container or zip lock bag until next use.

❼ Before each use check the connectors and tube for cracking, dislocation, or discolouring. If any of these are observed a new extension set must be used.

*Please note, this item is single patient use and is recommended to be used for up to 2 weeks only. Total use time can vary and your healthcare professional will advise of when to replace it.